

*Working as a structural design  
Fabrication and construction of  
Pre-engineered steel structure  
for Industrial shed,  
Multitoned building  
Warehouse, True Building  
&  
all Kinds of Steel building*



• Engineering    • Manufacturing    • Construction



**H.Z. STEEL**  
Structure Constructions

**বেয়াস চট্টগ্রাম সিটি কর্পোরেশন**  
 ১৯ই আগস্ট ২০১৭ সালের ৩০শে জুন ২০১৭

পাইসেস ইস্যুর বিভাগ	কর্তা	বিচারক
১০০০০	৩০	০০

**52756**

**ট্রেড লাইসেন্স (TRADE LICENCE)**

এই লাইসেন্সটি প্রদান করা হয়েছে ১০০০ টাকার মূল্যে এবং ৩০ দিনের জন্য।



- মাফিকের নাম : **ডঃ আবদুল হাকিম আলী**
- শ্রিতা/পেশার নাম : **ডাক্তার**
- মাসতার নাম : **আবদুল হাকিম আলী**
- মাফিকের ঠিকানা : **আবদুল হাকিম আলী**

বর্তমান বসবাসের ঠিকানা : **আবদুল হাকিম আলী**  
 হোল্ডিং নং : **১**  
 রোড নং : **১**  
 থানা : **আবদুল হাকিম আলী**  
 ইউনিয়ন : **আবদুল হাকিম আলী**

১০. মূল্য : **১০০০**  
 ১১. ট্রেড লাইসেন্স/নবায়ন ফি (বার্ষিক) : **৪০০**  
 ১২. প্রিন্টিং চার্জ : **৪০০**

১৩. প্রিন্টিং চার্জ : **৪০০**  
 মোট : **১৮০০**  
 প্রিন্টিং চার্জ : **৪০০**  
 মোট : **১৮০০**

১. নাম : **১৩৭৭১২০**  
 ২. নাম : **১৩৭৭১২০**  
 ৩. নাম : **১৩৭৭১২০**  
 মোট : **১৩৭৭১২০**  
 মোট : **১৩৭৭১২০**

৪. নাম : **১৩৭৭১২০**  
 মোট : **১৩৭৭১২০**  
 মোট : **১৩৭৭১২০**

৫. নাম : **১৩৭৭১২০**  
 মোট : **১৩৭৭১২০**  
 মোট : **১৩৭৭১২০**



**Government of the People's Republic of Bangladesh**  
**National Board of Revenue**

Mushak-2.3

Customs, Excise and VAT Commissionerate, Chittagong  
Agrabad Division

**Value Added Tax Registration Certificate**

This is to certify that the person whose details are given below is registered under  
Value Added Tax and Supplementary Duty Act, 2012 (Act No. 47 of 2012)

**BIN : 001254403-0503**

Name of the Entity	: M/S H. Z. STEEL STRUCTURE CONSTRUCTIONS
Trading Brand Name	: N/A
Old BIN	: N/A
e-TIN	: 313585193224
Address	: Hakkani Iron Market, Sagorika Road, North Kattoli; Pahartali PS; Chittagong-4202; Bangladesh
Issue Date	: 25/11/2020
Effective Date	: 08/04/2018
Type of Ownership	: Partnership
Major Area of Economic Activity	: Services



*This is a system generated certificate and doesn't require any signature*



**Government of the People's Republic of Bangladesh**

**National Board of Revenue**

**Taxpayer's Identification Number (TIN) Certificate**

**TIN : 313585193224**

This is to Certify that **M/S H. Z. STEEL STRUCTURE CONSTRUCTIONS** is a Registered Taxpayer of National Board of Revenue under the jurisdiction of **Taxes Circle-012**, Taxes Zone **01, Chittagong**.

**Taxpayer's Particulars :**

- 1) Name : **M/S H. Z. STEEL STRUCTURE CONSTRUCTIONS**
- 2) Registered Address/Permanent Address : **HAKKANI IRON MARKET, PLOT # 9, SAGARIKA I/A, Pahartali, Chattogram, PO : 4219, Bangladesh**
- 3) Current Address : **HAKKANI IRON MARKET, PLOT # 9, SAGARIKA I/A, Pahartali, Chattogram, PO : 4219**
- 4) Previous TIN : **Not Applicable**
- 5) Status : **Firm**

Date : November 01, 2020

**Please Note:**

1. A Taxpayer is liable to file the Return of Income under section 75 of the Income Tax Ordinance, 1984.
2. Failure to file Return of Income under section 75 is liable to:
  - (a) Penalty under section 124; and
  - (b) Prosecution under section 184 of the Income Tax Ordinance, 1984.



**Deputy Commissioner of Taxes**  
Taxes Circle-012  
Taxes Zone 01, Chittagong  
Address : HOUSE-149, ROAD-1/1, CDA R/A, AGRABAD,  
CHITTAGONG Phone : 031-726030

N. B: This is a system generated certificate and requires no manual signature.

Name of the company	: <b>H.Z Steel Structure Construction</b>
Address	: <b>Head Office &amp; Factory: Hakkani Iron Mart, Plot #9 Sagarika Industrial Area, Chittagong-4219 Dhaka Office : Durolp Villa 1St Floor , House -05, Road -2/A Sector -04 utara , Dhaka-1230</b>
Telephone	: <b>+8802-43150077(Head Office ) +8802-48956043(Dhaka Office )</b>
Mobile	: <b>+8801823-956225 +8801675-768206</b>
E-mail	: <b>hzsteel.sc@gmail.com</b>
Web	: <b>www.hzsteel.com.bd</b>
Principal Bankers	: <b>IFIC Bank Ltd. Southeast Bank Ltd. United Commercial bank limited(UCB)</b>
BIN	: <b>001254403</b>
Year of Incorporation	: <b>2015</b>
No. of Employees	: <b>Corporate Office Employees Engineers, detailers, Salas &amp; Marketing, Commercial &amp; Procurement, Accounts &amp; Admin&amp; HR- 22 Person Factory Employees : Production Manager, R &amp; D, QC, Delivery, Maintenance, admin- 13 Person Site Employees : Erection Co-Coordinator , Site Engineers, Supervisor , accountant &amp; storekeeper.-10 Person</b>
Board of Directors	: <b>Md. Habibur Rahman As a Chairman : Mrs Shamema akter , As a Vice Chairman : Md. Johir uaddin Chowdory, As a Managing Director : Md Saife Satter , As a CEO</b>

## WELCOME TO HZ STEEL

HZ Steel Structure Construction.(H.Z.SSC) incorporated in Bangladesh response to the increasing demand for quality Pre-Engineered steel building especially in the industrial sector. **H.Z.SSC** is looking for to managing, seeking xpertise and obtaining technology to provide Engineering solution by supplying steel building systems with quality for next generation leader and best customer services. Usually Pre Engineered steel buildings are always preferred for factories, warehouses, hall rooms, workshops, aircraft hangers, office buildings, commercial showrooms, distribution centers, supermarkets, restaurants and residential buildings. These services encompass a wide range of fully supported steel metal roofing, cladding galvanized structural decking, purlin, all necessary building accessories, structural steel design. **H.Z.SSC** aims to be recognized as the leading one -stop total solution provider in the field of steel buildings. We believe that by providing state -of -the- art technology, industry leading expertise and high quality support services, we will not only sustain our leadership in pre-engineered steel building construction business in Bangladesh but will reach even newer heights of professional excellence. It is this quest for excellence that has already earned the Company recognition and goodwill amongst leading business houses of the country. Our investment in well-groomed human resource and state-of-the-art technology is definitely poised to meet the challenges of the 21st century and create an impact on the economy of Bangladesh. Customer satisfaction, trouble free construction, accurate fit of components are priorities of **H.Z.SSC** regardless of the complexity of the project, thus resulting in reduced on -site erection cost in terms of time and money....



### Mission

To be the world's most reliable and innovative manufacturer, services and solution provider in the steel building industry. To manufacturer high quality innovative steel structure using lasts technology.

### Vision

- ▶ To Supply high quality steel products providing related services and solutions to the customers .
- ▶ To be premier in domestic steel market enhancing quality of fabrication, Erection And design capabilities.
- ▶ Leading to add value to our customers .

- Gaouchia Iron Mart .
- Gaouchia Steel Solutions
- Pharma Tex (Easy Systems weighing)





# The Pre-Engineered Building System

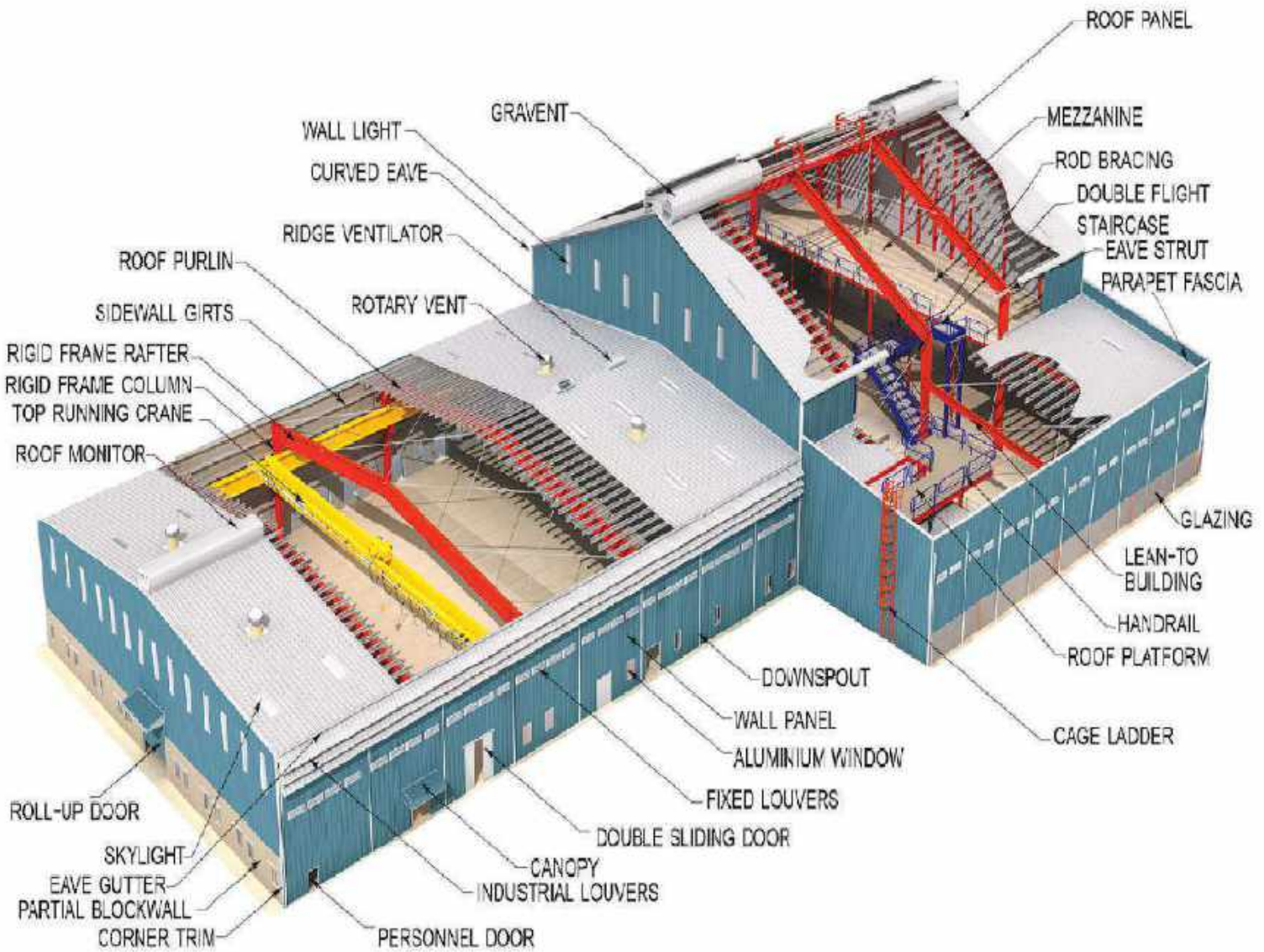

**Building Width:** Building Width is the distance measured from outer point of eave strut of one sidewall to the outer point of the eave strut of the other sidewall.

**Building length:** Building length is the distance measured from outer point of the flanges associated in the end wall columns to the outer point of flanges in the opposite end wall columns. The summation of end bays and interior bays within the building is actually creates the length of a building.

**Building Height:** Building height, technically known as eave height, is the distance measured from the bottom of the base plate of the main frame column to the top outer point of the eave strut. When columns are elevated from finished floor, eave height is the distance measured from finished floor to top of the eave strut.

**End Bay Length:** End bay length is the distance measured from outside of the outer flange of end wall columns to the center line of the first interior frame columns.

**Interior Bay Length:** Interior bay length is the distance measured from the center line of two nearest interior columns of the building's main frame.

The most common bay lengths are usually 6 meter, 7.5 meter and 9 meter. Any bay length up to 15 meter is possible.

**Roof Slope (1:X ):** Roofslope is actually the angle originated from the inclined roof surface with respect to the horizontal surface.

Variation of roof slope is possible upto a practical limit but the most common roof slopes are usually 1:6, 1:8 and 1:10.

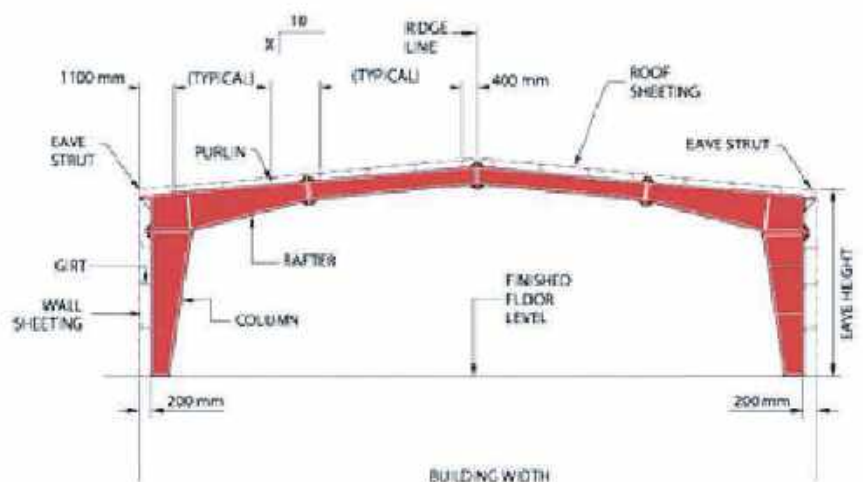
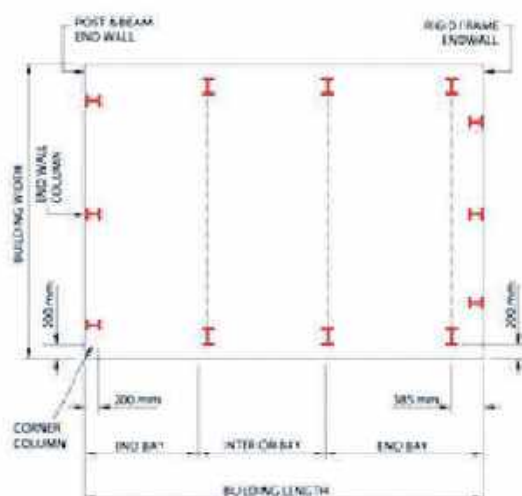

The most common framing systems are described below. Most of the frames are symmetrical about the ridge line, Unsymmetrical frames and geometrically any forms of frames are possible.

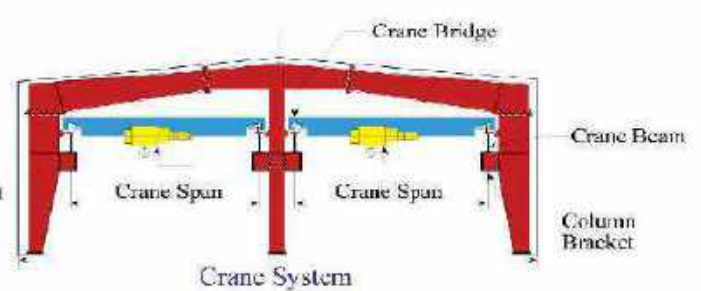
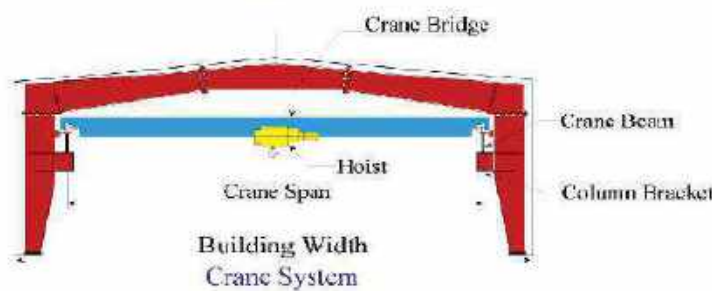
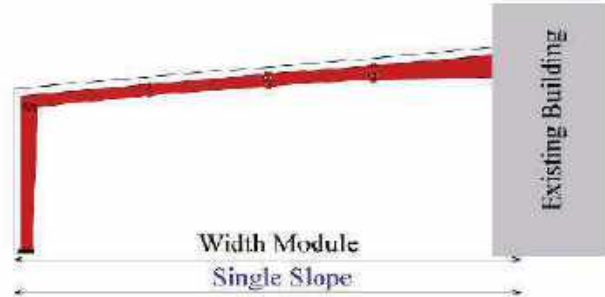
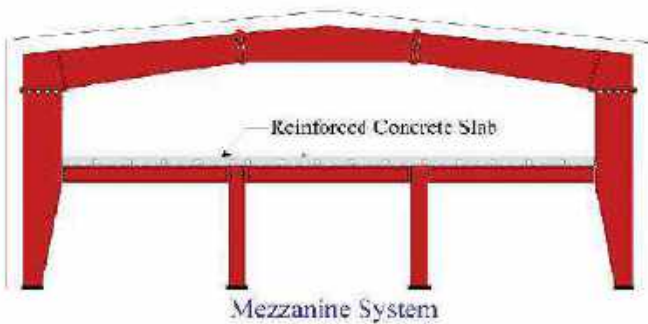
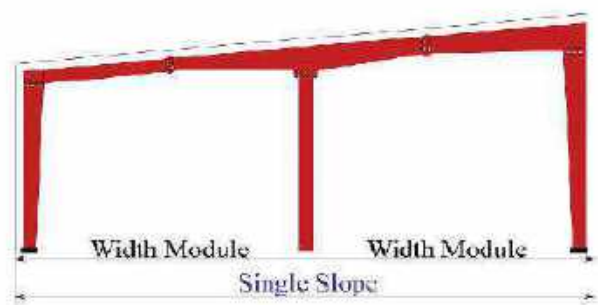
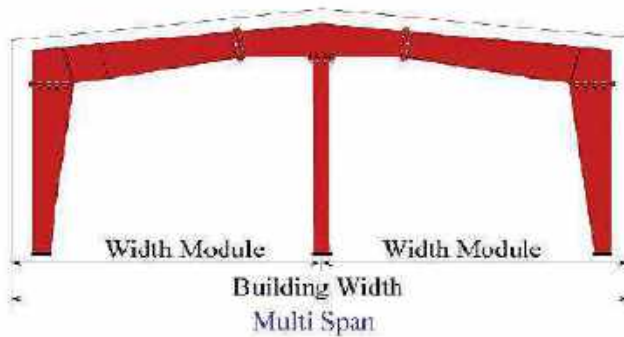
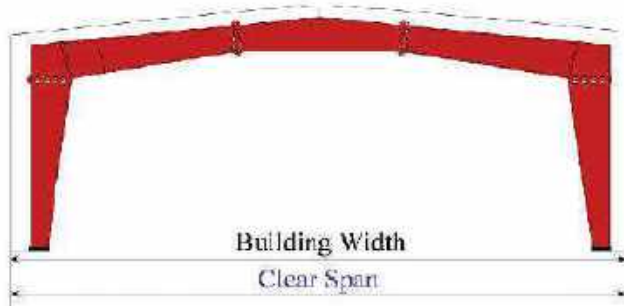



ENDWALL ROOF EXTENSION



SIDEWALL ROOF EXTENSION

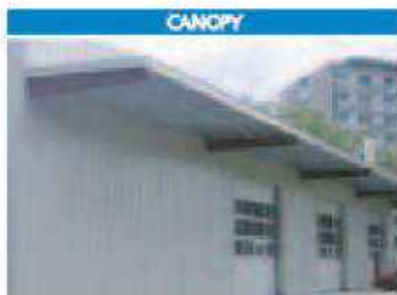
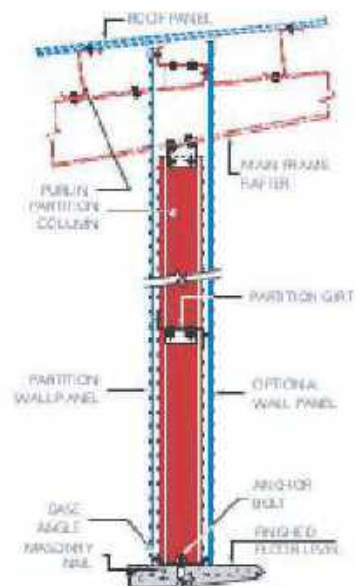
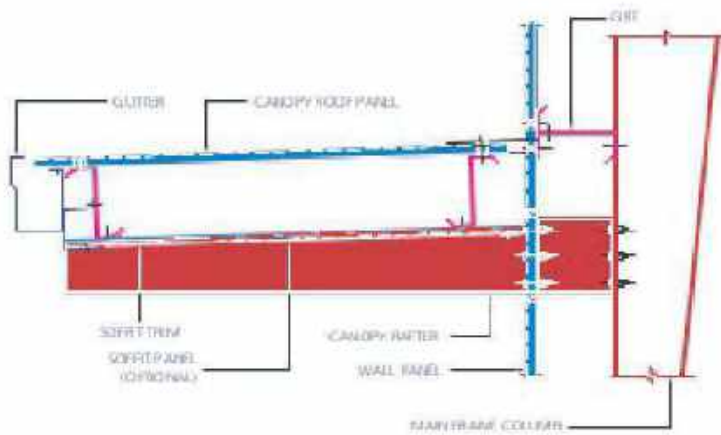
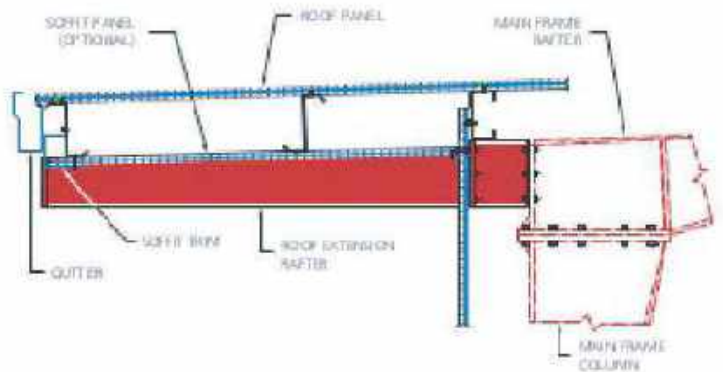
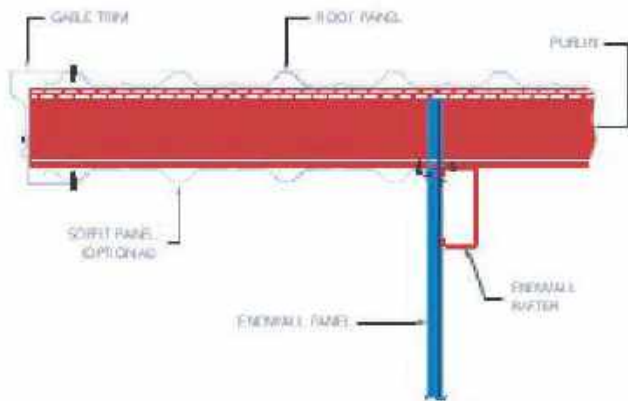

CANOPY



LONGITUDINAL PARTITION

# Mezzanine And Crane Systems

Standard mezzanine floor system consists of galvanized/MS steel decking supported by joists framed onto mezzanine beams. The primary mezzanine beams normally run across the width of the building and the joists normally run lengthwise.

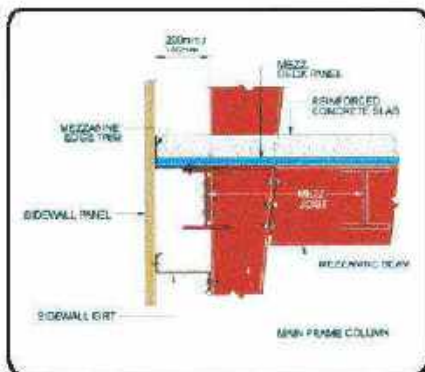
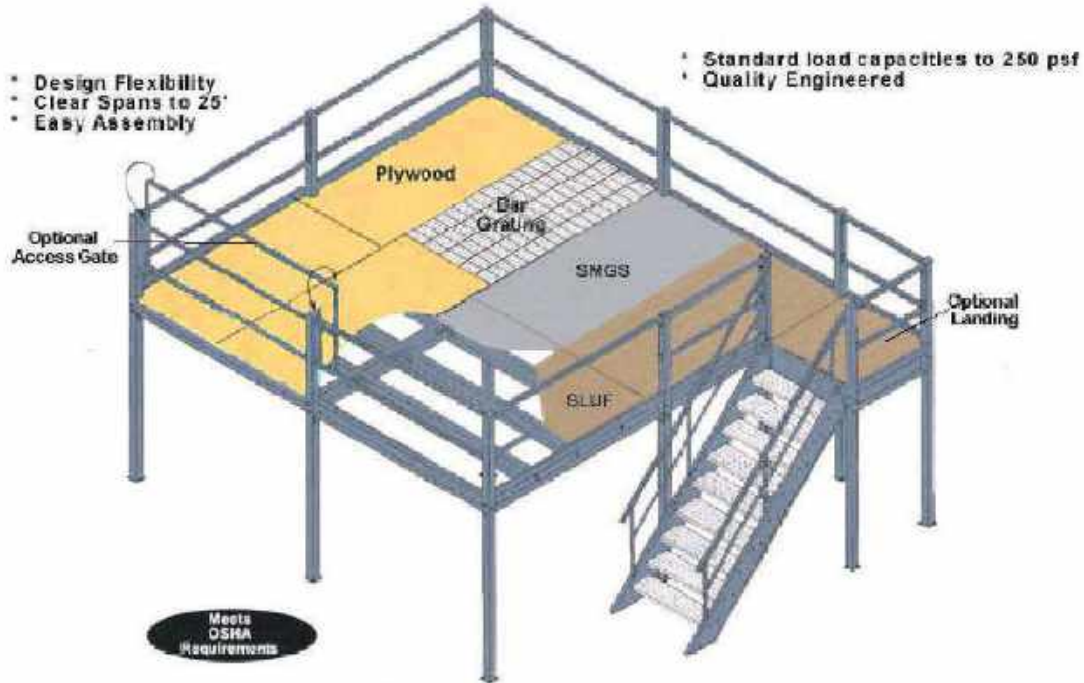

Mezzanine Beam Connection to Main Frame Column

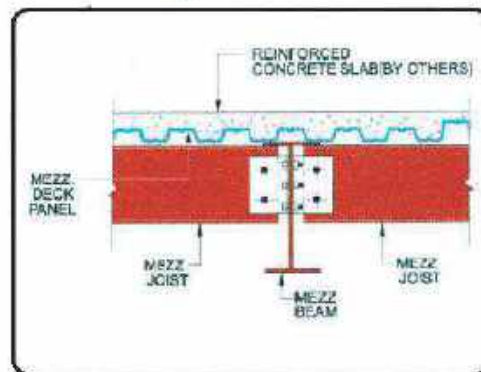

Mezzanine Joist Connection to Mezzanine Beam

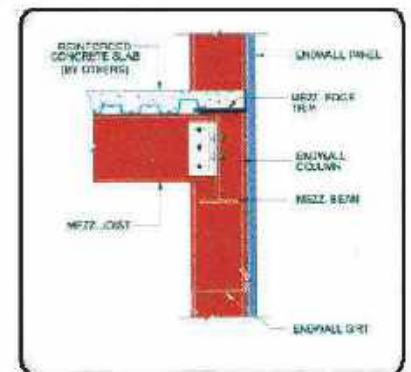

Joist Connection to End wall Column

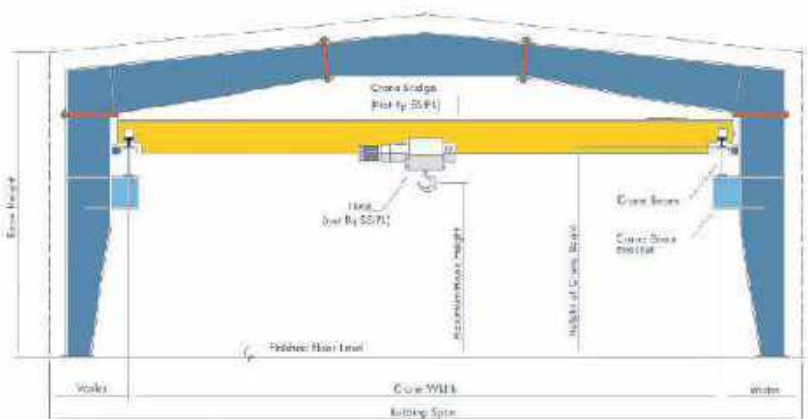
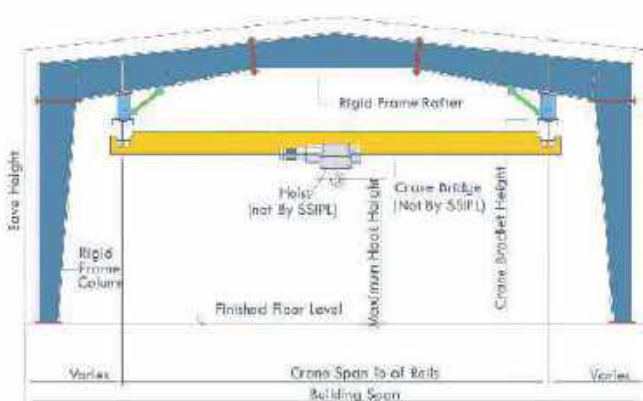

## Secondary members:

High strength MS or galvanized steel Z or C shape purlin available in 1.6mm, 1.75mm, 2.0mm and 2.5mm thickness, conforming to ASTM A607 grade 50 (or equivalent)

Factory painted with a minimum of 35microns (DFT) of red oxide primer or galvanized or any other paint system as per customer's choice.

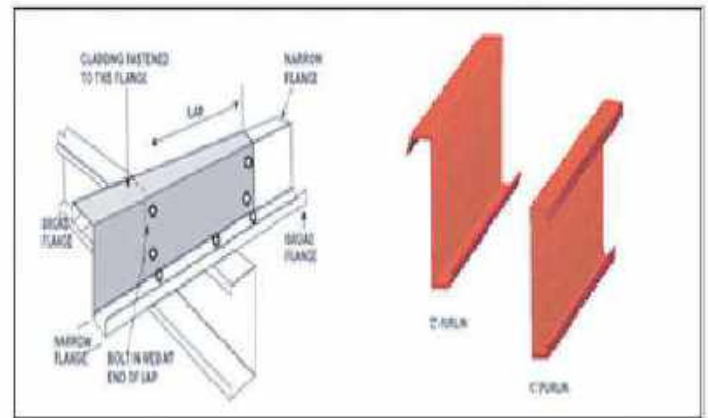

## Bracing Systems:

Cable bracing is normally used. Cables used for bracing system conform to the physical specifications of ASTM A475 extra high strength galvanized strands. Other bracing (angle, rod, portal) systems are also available as per design requirements.

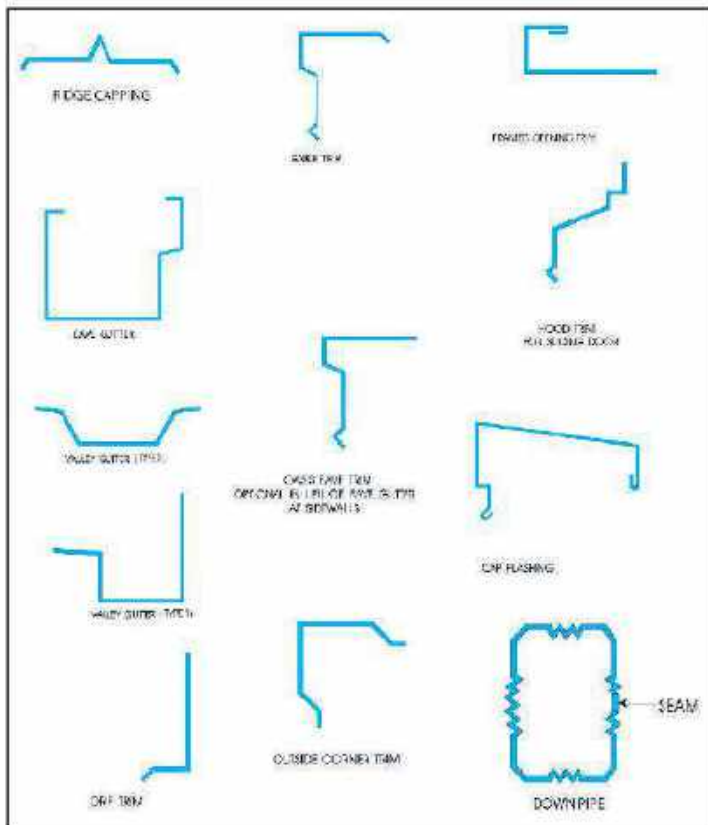
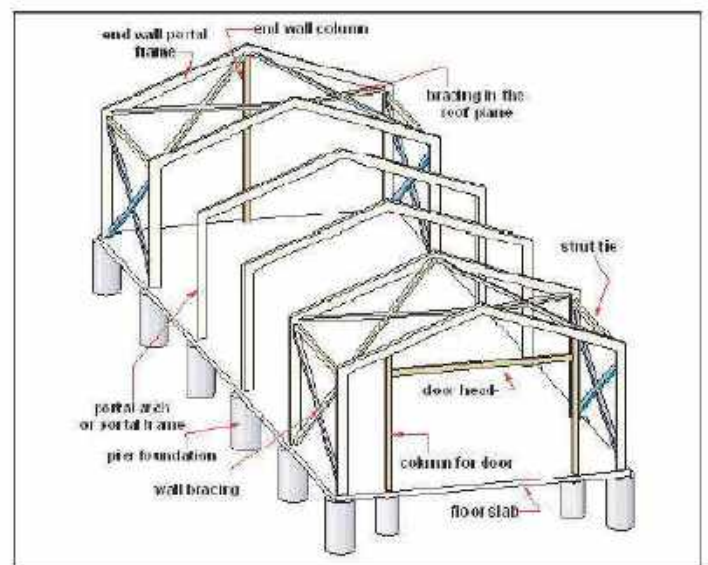

## Trims, Cap & Gutter

## Sandwich Panel

Color steel sandwich panel has a good fire proof and heat insulation performance for the characteristic of the color steel sheet and EPS (or fiber glass wool, Rock wall and PU) materials



## Profile Specifications

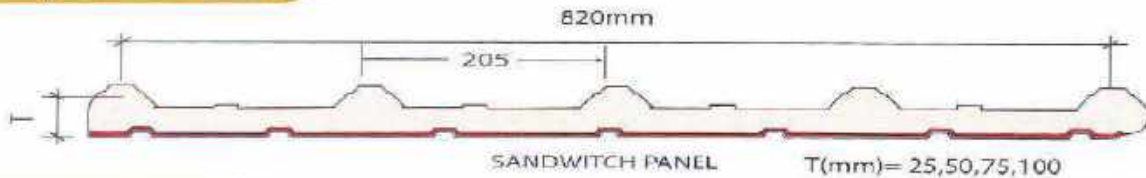

## Translucent Sheet

2mm - 4mm thick translucent Sheet for sky light is made fiber glass profile sheet.



## Decking Panel

Profile Specifications

Decking panel is manufactured from tased galvenized or pre-painted coils as per ASTM & ASI397 grade G-345. It can be roll-formed from hot dipped, zinc-coated, high tensile steel. Decking panel profiles are rolled out in thickness varying from 0.45mm to 1.00mm and with length having from 600mm to 1200mm.



## Profile Specifications

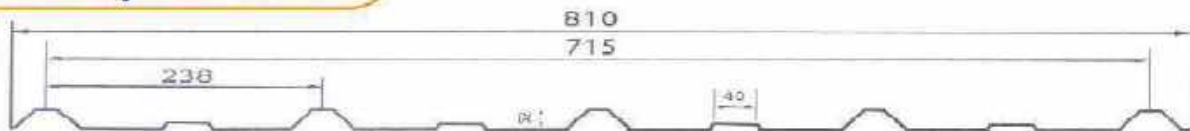

## Insulated Panel

### Poly Foil

Poly foil insulation available in 4mm to 25mm thickness with or without glue. Thermal conductivity - 0.029 W/mk@27C



### Air Bubble

Air Bubble aluminum foil insulation available in 5mm to 10mm thickness. Thermal conductivity - 0.001 W/mk@27C

### Glass Wool

Glass Wool blanket with separate aluminum foil available in 25mm to 50mm thickness. Thermal conductivity - 0.0255-0.0284W/mk@30C. Density - 16~kg/M3 minimum.



All buildings are designed in accordance with the following codes that dictate the design and manufacture of pre-engineered steel buildings.

Loads are counted in accordance with:

- ▶ Bangladesh National Building Code, 1993
- ▶ The 1996 edition of the Low Rise Building System Manual Metal Building Manufacturers Association (MBMA)
- ▶ 1230 Keith Building, Cleveland, Ohio 44115-2851

Built-up and hot rolled sections are designed in accordance with:

- ▶ Manual of Steel Construction - Allowable Stress Design  
American Institute of steel Construction (AISC)  
1, East Wacker Drive, Suite 3100, Chicago, Illinois 60601-2001, USA.

Welding is applied in accordance with:

- ▶ 1996 American Welding Society (AWS D.1.1.96)  
Structural Welding Code - Steel Manual  
550 NW Lejeune Road, Miami, FL33135, USA

Connections are designed in accordance with:

- ▶ Manual of Steel Construction Volume II Connections (ASD 9th Edition/LRFD 1st Edition)  
American Institute of steel Construction (AISC)  
1, East Wacker Drive, Suite 3100, Chicago, Illinois 60601-2001, USA.





Self Drilling Fasteners



Anchor Bolts



Nut-Bolts



Roof Rotary Ventilator



Small Louver



Curve Sheet

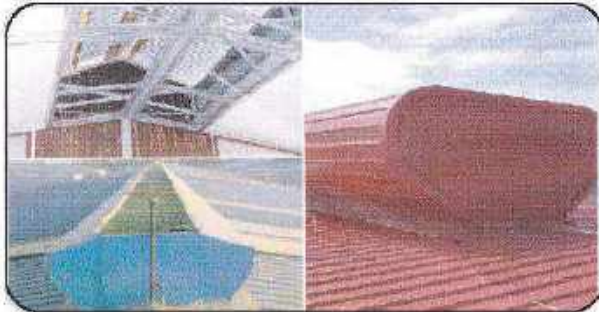

Ridge Ventilation System



Transparent Sheet

## Color Profile Sheet

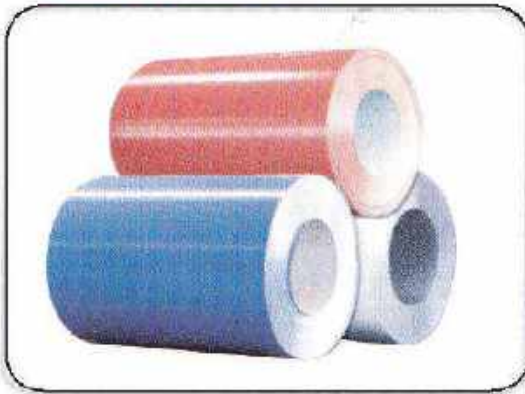

Pre-painted Color Coil

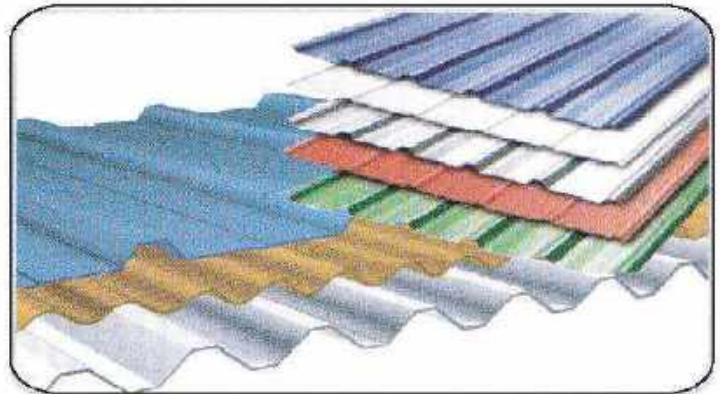

Profile Sheet

## Standard Panel Colors



Mist Green



Dark Red



Brick Red



Sea Blue



Royal Blue



Off White

L No	Name of the Client	Project Name	Location	work tile
1	Mr.Azizur Rahman	Anisa Engineering Works - ware house	Chittagong	Complete Job
2	Mr . Adul Karim	Khan karim Conversion Hall	Chittagong	Complete Job
3	Mr. H Rahman	H.M. Rahman LPG Gas Plant	Feni	Complete Job
4	Four star syndicate	Four star CNG Pump	Chittagong	Complete Job
5	Four star syndicate	Residential Shade(Steel)	Chittagong	Complete Job
6	Borhani Corporation	Borhani Automatic cutting Plant	Chittagong	Complete Job
7	Mr.Azizur Rhaman	Anisa Engineering Works--2-ware house	Chittagong	Complete Job
8	Iron Built .	APC-Chimney ,Duct line , Hood Canopy. Hopper	Chittagong	Fabrication & Erection
9	Sunflower Inn.(China)	Tally Carcen Installation in-kornofully tunnel	Chittagong	Fabrication
10	Organic Jeans ltd(mr.Kabir)	6storied building repetitive work	Chittagong	Fabrication & Erection
11	Sin- hydro corporation limited	Shittalakh 3rd bridge Project	Naranyanganj	Supply Materials & Fabrication Work.
12	Havvey equipment BD Ltd(China )	Moheskali power project	Coxbazar	Supply Materials & Fabrication Work.
13	port City International University (AK Traders)	Canteen building , Emergence out side steel stair	Chittagong	Fabrication
14	Iron Built Building Manufacture Construction .	Agate feed mills ltd-ware House	Camilla	Fabrication Work
15	Iron Built Building Manufacture construction .	Globe fish proc.-3storied steel Building	Nohakali	Fabrication Work
16	Iron Built Building Manufacture Construction .	Globe biscuit& dairy milk ltd.-6storied steel Building	Nohakali	Fabrication Work
17	Iron Built Building Manufacture construction .	Globe fish proc.-3storied steel Building	Nohakali	Fabrication Work

L No	Name of the Client	Project Name	Location	work tile
18	Iron Built Building Manufacture construction .	Globe Pharmaceutical Ltd.- 5storied steel Building	Nohakali	Fabrication Work
19	Iron Built Building Manufacture construction .	Globe fish mail & oil Plant.- steel Building	Nohakali	Fabrication Work
20	Iron Built Building Manufacture construction .	Aci bicycle -2storied Steel building	CEPZ	Fabrication Work
21	Iron Built Building Manufacture construction .	Fayha beverage-Steel building	Chittagong	Fabrication & Erection
22	Iron Built Building Manufacture construction .	BSRM -steel Shade- (Baroawlia)	Chittagong	Fabrication & Erection
23	Iron Built build in Manufacture construction .	Ever Tube (BD)-Emergence out side steel stair -6storied	CEPZ	Fabrication & Erection
24	Iron Built building Manufacture construction .	Emergence out side steel stair	CEPZ	Fabrication & Erection
25	Iron Built building Manufacture construction .	Globe biscuit& dairy milk ltd.-roof top Canteen & 3Storied workshop	Nohakali	Fabrication Work
26	Iron Built building Manufacture construction .	Van-cot Ltd-steel stair unground floor	KEPZ	Fabrication & Erection
27	Iron Built building Manufacture construction .	Baste BD Ltd- Maize-main floor work	KEPZ	Fabrication & Erection
28	Eng. Mr. Kajol (Ajmir Enterprise)	BSRM-over Head Crane Installation -Mirrasarai	Chittagong	Fabrication Work
29	Eng. Mr. Kajol (Ajmir Enterprise)	Bangladesh Cost grud-Steel bridge	Chittagong	Fabrication Work
30	Eng. Mr .Kajol (Ajmir Enterprise)	United Group-Tank terminal	Chittagong	Pipe line work
31	Tiger Steel BD Ltd	Gomuti bridge -repetitive Work	Camilla	Supply Materials & Fabrication Work.
32	Tiger Steel BD Ltd	Crown Wares Ltd (Ware House)	Valuka	Fabrication Work

# Client List

L No	Name of the Client	Project Name	Location	work title
33	Tiger Steel BD Ltd	Crown Washing Unit-2,	Valuka	Fabrication Work
34	Tiger Steel BD Ltd	Universal Store Room Building	Tangail	Fabrication Work
35	Tiger Steel BD Ltd	Anan Footwear Ltd	Kapasias	Fabrication Work
36	Pulse Steel Ltd.	Kishan Agro Warehouse	Dhamrai	Fabrication Work
37	Pulse Steel Ltd.	Saham Sweetor ltd-factory Shade	Hobigonj	Fabrication Work
38	Pulse Steel Ltd.	Label Edge Ltd-6Stoired Steel building	Dhamrai	Fabrication Work
39	Pulse Steel Ltd.	JFZ Laval and painting Company ltd.-factory building	Naranyanganj	Fabrication Work
40	MRF Steel Build systems	Master Show-ware house	kisorgonj	Fabrication Work
41	MRF Steel Build systems	Top poly Mar ltd.-3storied steel factory shade	Gajipur	Fabrication Work
42	MRF Steel Build systems	bro Madrasa 3storied residential Steel building	jatrabari	Fabrication Work
43	Universal Steel & Concrete Technology	"Para Center"-A project of UNICEF	Rangamati	Fabrication Work
44	Zin Nurain Steel	Bonoful group ltd-Factory shade	Chittagong	Fabrication Work
45				
46	Cas BD ltd(Korea)	21m.Weighing Bridge Supply	kornofully tunnel-Chittagong	Fabrication Work
47	China Railway Group Limited (Pharma tex)	15m.Weighing Bridge-Padma bridge	Faridpur	Fabrication & Installation work
48	China Railway Group Limited (Pharma tex)	15m.Weighing Bridge(Supply)	Padma Bridge Rail Link Project Madharipur	Fabrication & Installation work
49	Rak Ceramics	15m.Weighing Bridge Supply	Gajipur	Fabrication & Installation work
50	Sena Khallan Ready Mix Concrete Limited	12m.Weighing Bridge(Supply)	Tongi	Fabrication & Installation
51	China Railway Group Limited (Pharma tex)	12m.Wighing Bridge(Supply)	Dhaka-Nariel Railway Project	Fabrication & Installation work
52	BH Brick Feld	9m.Wighing Bridge(Supply)	Gabali	Fabrication & Installation work
53	China Civil Engineering Construction Corporation. (Pharma tex)	9m.Wighing Bridge(Supply)	Embankment Of Mirsarai -2A EZ , Mirsarai , Chittagong.	Fabrication & Installation work
54	CG Foods Ltd (Pharma tex)	12m.Wighing Bridge(Supply)	Dhamari	Fabrication & Installation work
55	United Steel alliance	Pepala Ltd.-Six storied Building	CBPZ	Fabrication work
56	United Steel alliance	Rohinga Rehabilitation project-	Vasan-Char	Fabrication work



**H.Z. STEEL**  
Structure Constructions



**H.Z. STEEL**  
Structure Constructions

**DHAKA OFFICE**

Dorlub Villa, House # 05, Road#2/A,  
Sector# 4, Uttara, Dhaka-1230

**FACTORY OFFICE**

Hakkani Iron Market, Plot # 9,  
Sagarika Industrial Area, Chittagong.

Phone : +8801823-956225  
+8801675-768206

Mobile : +8802-43150077 (Head Office )  
+8802-48956043 (Dhaka Office)

E-mail : [hzsteel.sc@gmail.com](mailto:hzsteel.sc@gmail.com)

Web : [www.hzsteel.com.bd](http://www.hzsteel.com.bd)